

# 120° CAMERA

8 MP camera for Raspberry Pi

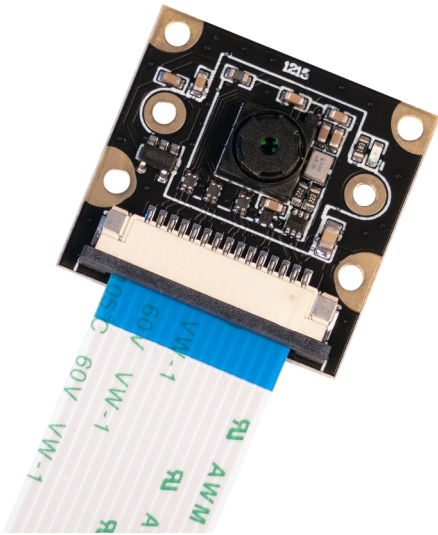

The camera module for all Raspberry models works with the well-known IMX219 chip and delivers best recordings in 8 MP quality with an angle of view of 120°.

Furthermore, it has the possibility to supply additional modules (e.g. lighting etc.) via its own power supply with up to 3.3 V voltage.

Through additional mountings in the board, you can install the camera individually or mount other Extensions.

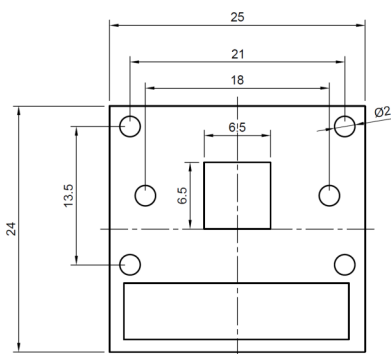

## MAIN FEATURES

Sensor	IMX219
Megapixel quantity	8 Megapixel
Angle of view (diagonal)	120°
Dimensions (WxLxH)	25x24x6 mm
Weight	4 g
Scope of delivery	RB-CAMERA-JT-V2-120

## OTHER SPECIAL FEATURES

Resolution	3280 x 2464 Pixel
Video resolution	1920 x 1080 @ 30 FPS
Interface	Camera Serial Interface CSI
Cable length	150 mm
Focal length	1.79 mm
Aperture (F)	2.0
Distortion	< 13.6%
Lens dimension	6.5 mm x 6.5 mm
More specifications	4 holes for screws provide 3.3V power output

## FURTHER DETAILS

Item number	RB-CAMERA-JT-V2-120
EAN	4250236824246
Customs tariff number	84733020